

SURVEY CONTROL DATA

SEE SURVEY DATA SHEETS

CITY OF ENID GARFIELD COUNTY

PLAN OF PROPOSED WATERLINE IMPROVEMENTS N. CLEVELAND STREET AND W. CHESTNUT AVENUE INTERSECTION W-1406B

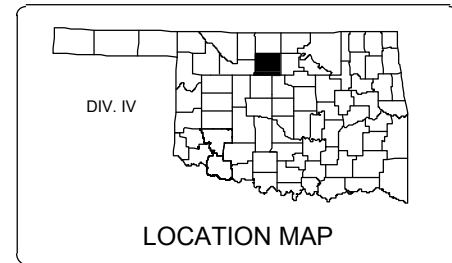

SCALES

PLAN 1"=30'
 PROFILE HOR. 1"=30'
 PROFILE VER. 1"=5'
 LAYOUT 1"=1000'

CONVENTIONAL SYMBOLS

- PROPOSED ROADS
- - - SECTION LINES
- · - · - QUARTER SECTION LINES
- X X FENCES
- - - EXISTING GRADE
- - - EXISTING ROADS
- - - BASE LINE
- - - PROPOSED GRADE
- TUG COMMUNICATION LINES (EXISTING)
- PA POWER LINES (EXISTING)
- OHE OVERHEAD POWER LINES (EXISTING)
- PUG POWER UNDER GROUND LINES (EXISTING)
- G GAS LINE (EXISTING)
- SS SANITARY SEWER LINES (EXISTING)
- ST STORM SEWER LINES (EXISTING)
- W WATER LINES (EXISTING)
- FO FIBER OPTIC LINES (EXISTING)
- TUG COMMUNICATION LINES (PROPOSED)
- OHE POWER LINES (PROPOSED)
- PUG POWER LINES (PROPOSED)
- G GAS LINE (PROPOSED)
- SS SANITARY SEWER LINES (PROPOSED)
- ST STORM SEWER LINES (PROPOSED)
- W WATER LINES (PROPOSED)
- FO FIBER OPTIC LINES (PROPOSED)
- /// BUILDINGS
- - - DRAINAGE STRUCTURES (EXISTING)
- - - DRAINAGE STRUCTURES (PROPOSED)
- - - RIGHT-OF-WAY LINES (EXISTING)
- - - RIGHT-OF-WAY LINES (PROPOSED)
- - - RIGHT-OF-WAY FENCE
- - - FLOWLINE (EXISTING)
- - - FLOWLINE (PROPOSED)
- - - TOE OF SLOPE (EXISTING)
- - - TOE OF SLOPE (PROPOSED)
- ||||| CITY LIMITS
- ~~~~~ LANDSCAPE
- ||||| RAILROAD

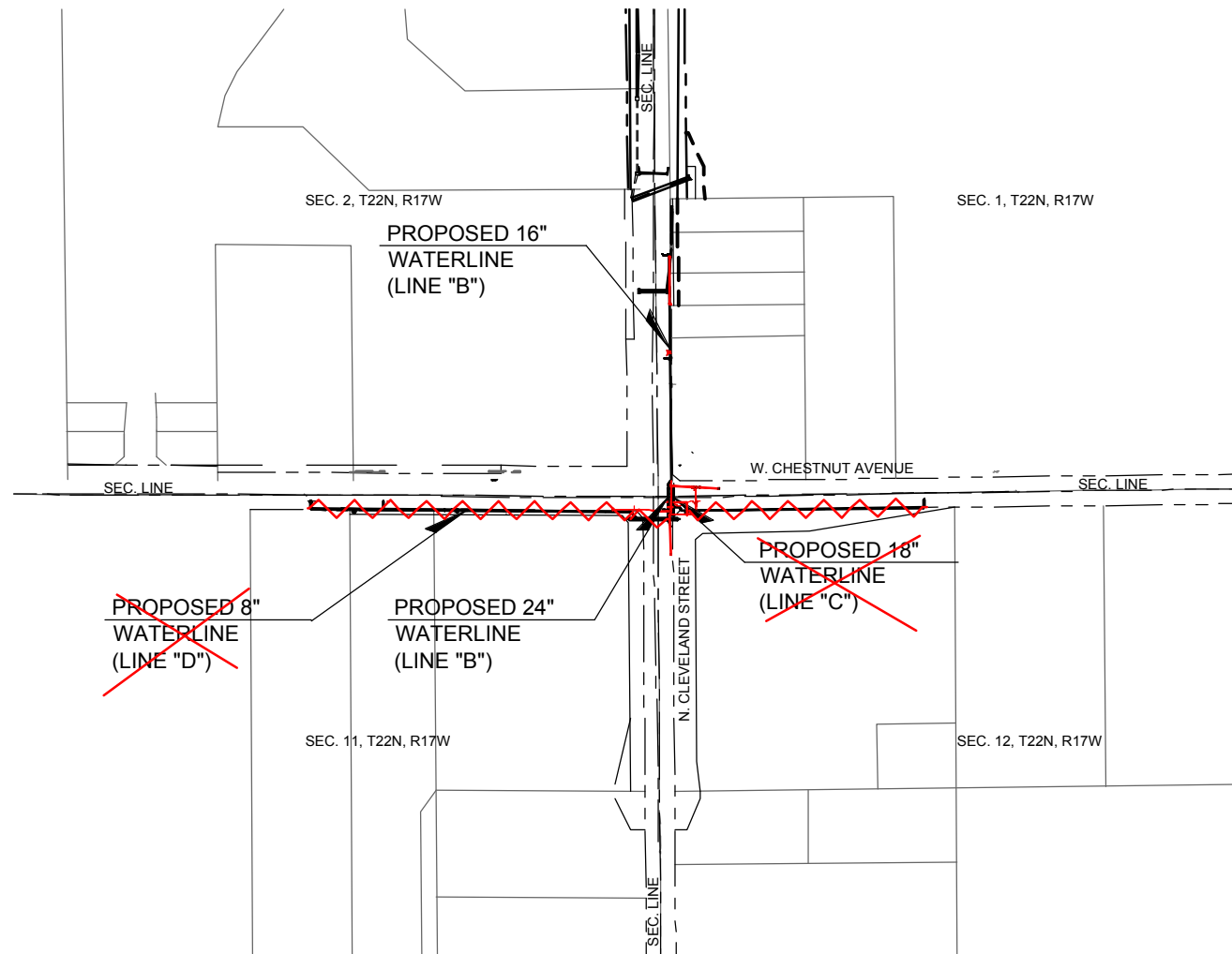

INDEX OF SHEETS

- 1 TITLE SHEET
- 2 STORMWATER MANAGEMENT PLAN
- 3 SUMMARY OF PAY QUANTITY NOTES (WATERLINE)
- 4 SUMMARY SHEET
- 5 GEOMETRIC DATA
- 6-7 PLAN & PROFILE - W. CHESTNUT AVE. - LINE "D"
- 8-9 PLAN & PROFILE - N. CLEVELAND ST. - LINES "B" & "C"
- 10 WATERLINE DETAILS
- 11-13 TCP - SEQUENCE OF CONSTRUCTION
- SD1-SD11 SURVEY DATA
- WD1-WD4 CITY OF ENID STANDARD DETAILS
- WD-5 WATERLINE NOTES & DETAILS

THE FOLLOWING CITY OF ENID STANDARD DRAWINGS SHALL BE REQUIRED FOR THIS PROJECT:

- SWD - 1 WATER LINE BLOCKING DETAILS
- SWD - 2 MISC WATER LINE CONSTRUCTION STDS (SHEETS 1 & 2)
- SWD - 4 TAPPING SADDLE & SERVICE TEE/WYE INSTALLATION
- SWD - 9 STD CONCRETE PIER AND SEWER-WATER LINE CROSSING DETAIL
- SWD - 10 PAVEMENT REPAIR FOR UTILITY CROSSING
- SWD - 11 WATER METER VAULT 1 1/2" & 2" METER (SHEET 1)
- SWD - 11 WATER METER VAULT 3", 4" & 6" METER (SHEET 2)

NOTES:

- SEPARATE RIGHT-OF-WAY PERMITS REQUIRED BY THE CONTRACTOR FOR WATERLINE, SEWER LINE, AND PAVING TO CONSTRUCT.
- CONTRACTOR SHALL CONTACT TOM HARRISON, CITY INSPECTOR, AT 580-231-2054 TO SCHEDULE A PRE-CONSTRUCTION MEETING.
- ALL TRACER WIRE (MAIN AND SERVICE LINES) SHALL BE INTERCONNECTED SO THAT LOCATES CAN BE PERFORMED FROM A SINGLE, ENERGIZED POINT.

RECORD DRAWING 4-28-17

ADDENDUM #3 11-15-16

RECORD DRAWING

LATEST CITY OF ENID STANDARD SPECIFICATIONS & ODEQ STANDARDS FOR CONSTRUCTION ENGLISH GOVERN. APPROVED BY THE CITY OF ENID.

EQUATIONS: NONE
 EXCEPTIONS: NONE

TETRA TECH

PREPARED BY:
 TETRA TECH
 FOR THE OKLAHOMA
 DEPARTMENT OF TRANSPORTATION

CA 2388 (EXP. 06-30-17) DATE

ENGINEER, P.E.
 OKLA. REG. NO. 22779

DATE _____ CITY OF ENID

CITY PROJECT NO. W-1406B

SHEET NO. 1

9/22/2017 1:56:47 PM - P:\277121\31-27712-13001\CAD\DWG\WATERLINE\PLANS\TITLESHEET.DWG - SCHUMACHER, MIKE